

# ***TOSVERT VF-AS3***

## **Flange mounting kit Instruction Manual**

---

**FOT018Z, FOT019Z, FOT020Z,  
FOT021Z, FOT022Z**

---

**TOSHIBA INDUSTRIAL PRODUCTS AND SYSTEMS CORPORATION**

### **NOTICE**

1. Make sure that this instruction manual is delivered to the end user of Flange mounting kit.
2. Read this manual before attaching the Flange mounting kit.  
Keep it in a safe place for reference.
3. All information contained in this manual will be changed without notice.



\*NVE34504REV00\*

**FOT018Z**

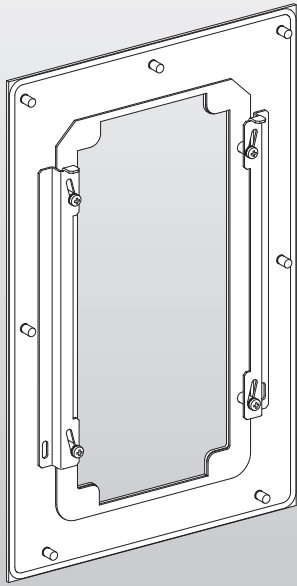

 9 x M6

**FOT019Z**

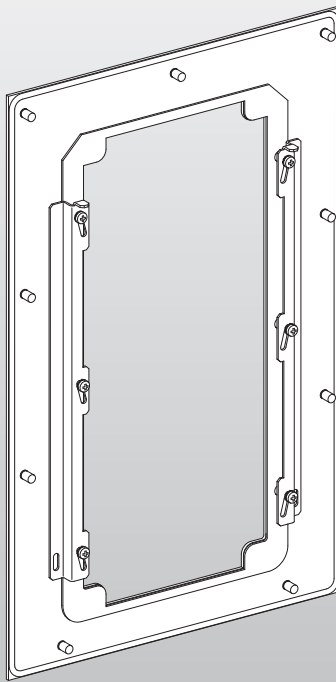

 9 x M6

**FOT020Z**

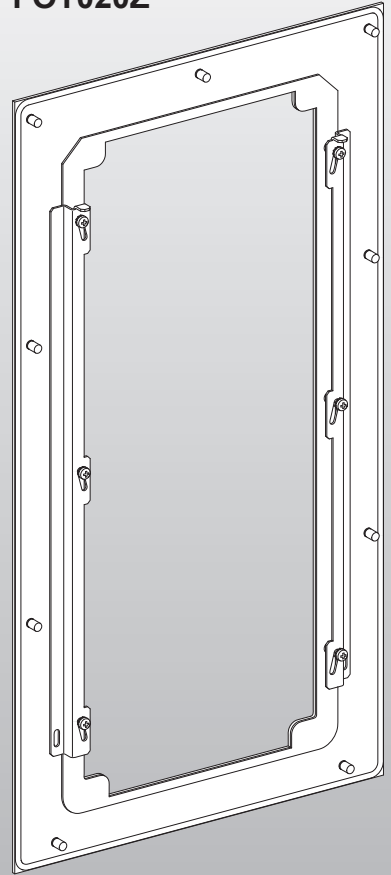

 9 x M6

<b>FOT018Z</b>	VFAS3-2004P, VFAS3-2007P, VFAS3-2015P, VFAS3-2022P, VFAS3-4004PC, VFAS3-4007PC, VFAS3-4015PC, VFAS3-4022PC, VFAS3-4037PC	<b>PAGE 1-4</b>
<b>FOT019Z</b>	VFAS3-2037P, VFAS3-4055PC, VFAS3-4075PC	<b>PAGE 1-4</b>
<b>FOT020Z</b>	VFAS3-2055P, VFAS3-2075P, VFAS3-4110PC, VFAS3-4150PC, VFAS3-4185PC	<b>PAGE 1-4</b>

<p><b>▲ CAUTION</b></p> <p><b>HAZARD OF EQUIPMENT DAMAGE</b> Respect the information provided in the instruction to ensure the functioning of the product. <b>Failure to follow these instructions can result in injury or equipment damage.</b></p>
--

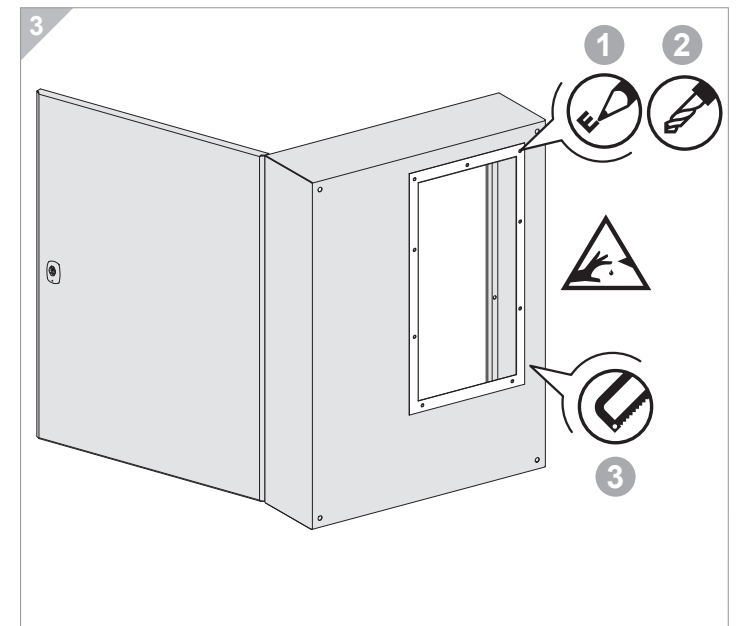
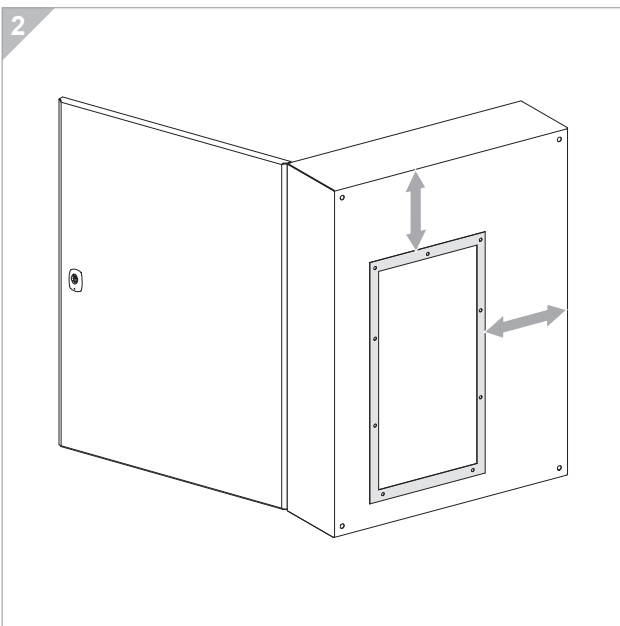
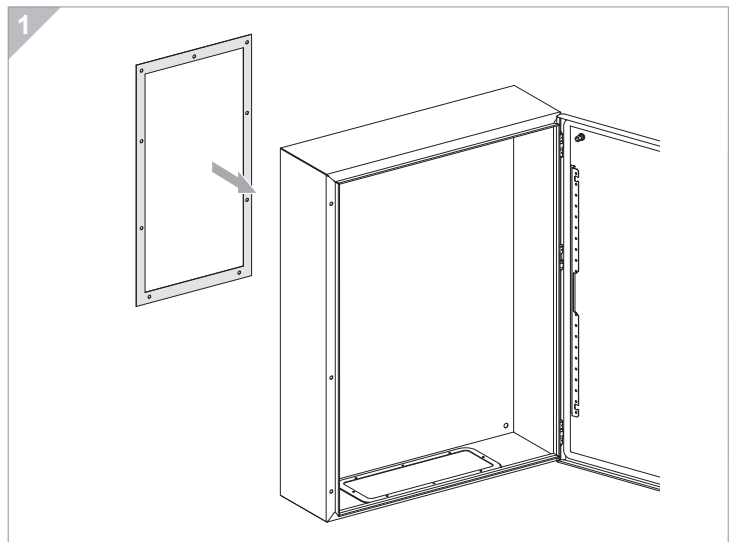
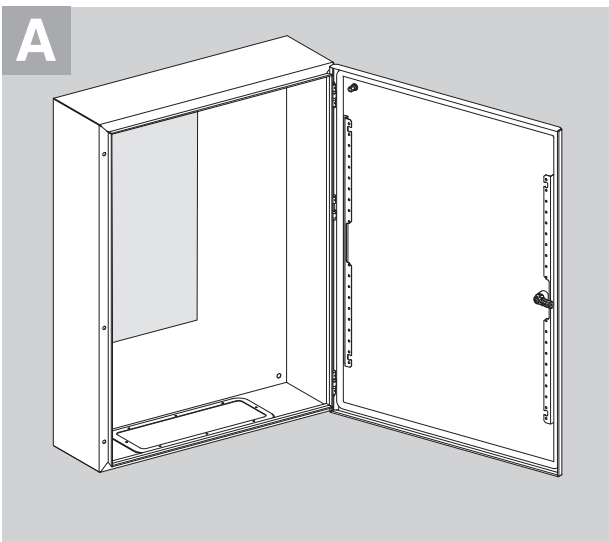
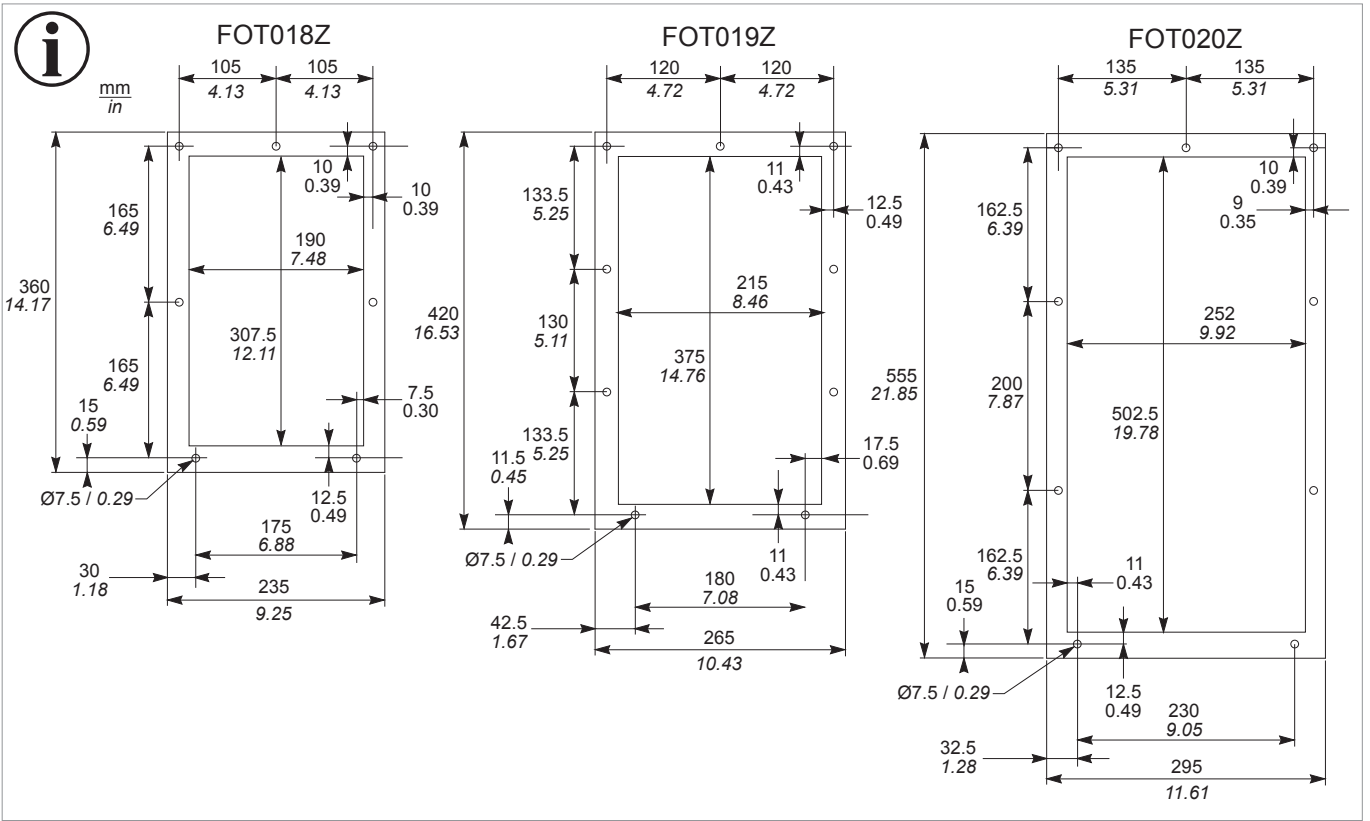

**B**

FOT018Z  
FOT019Z  
FOT020Z

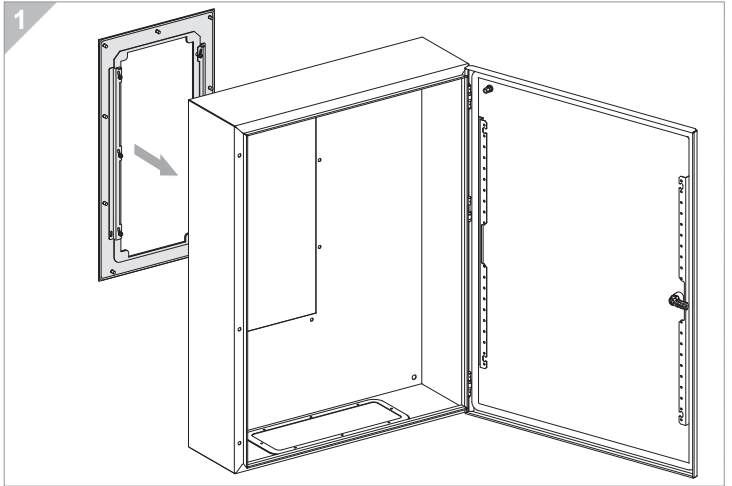
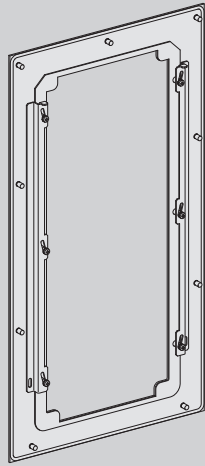

**2**

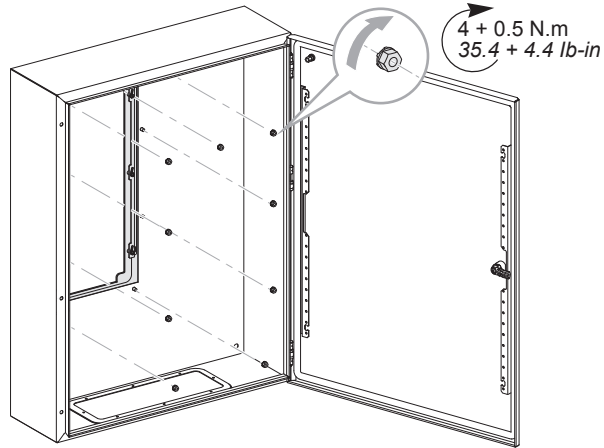

FOT018Z x 7  
FOT019Z x 9  
FOT020Z x 9

**C**

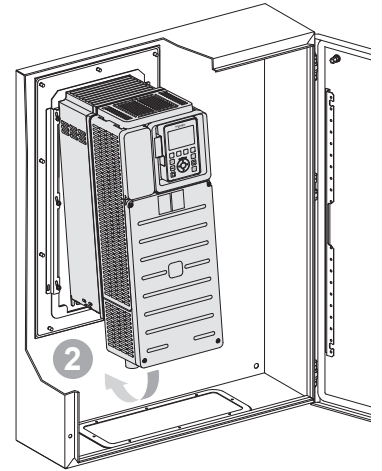
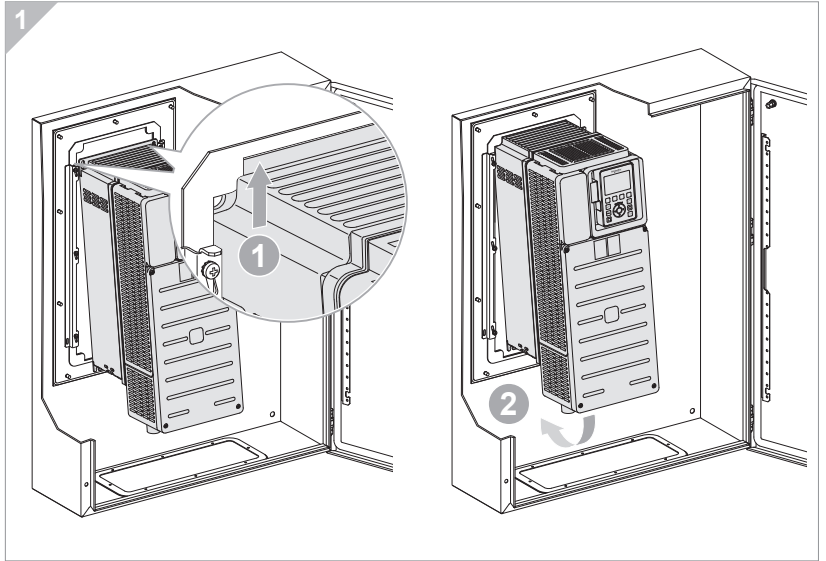
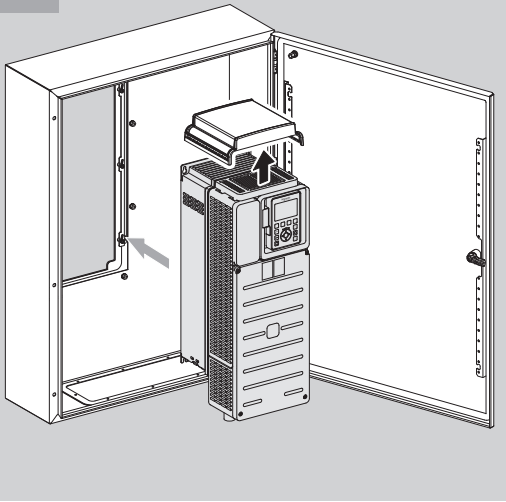



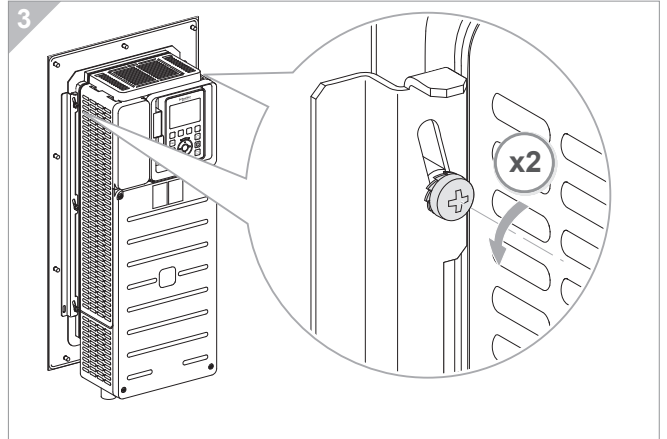
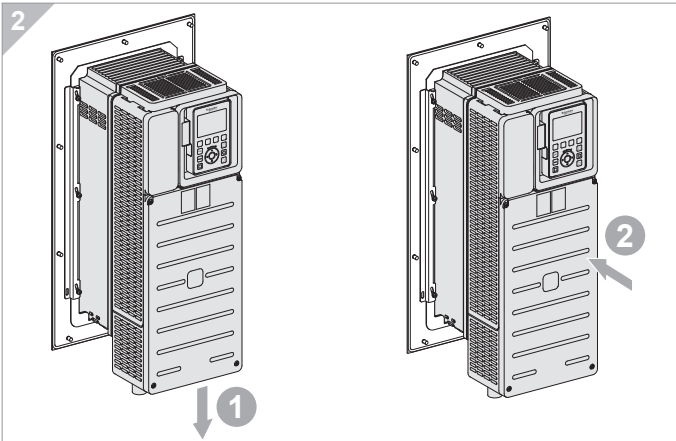

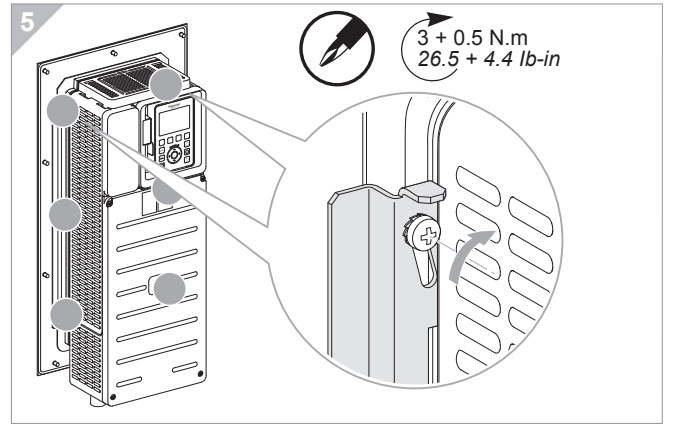
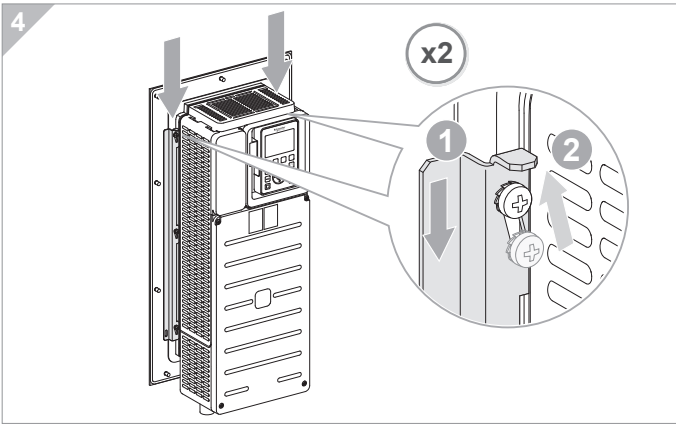
**2**



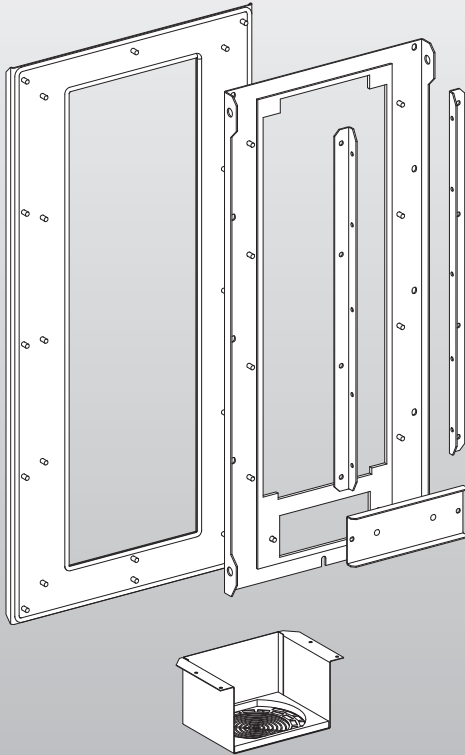





**FOT021Z**

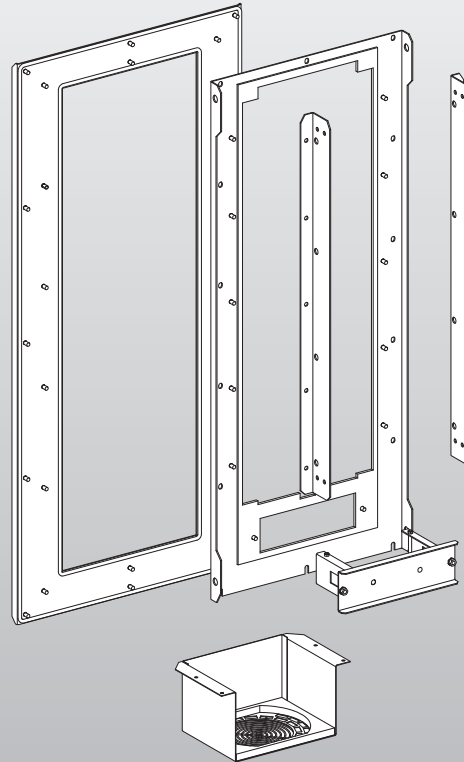

-  29 X M6
-  10 X M4
-  2 X M4
-  2 X M4  
(L=50mm)

**FOT022Z**



-  29 X M6
-  8 X M6
-  2 X M4

<b>FOT021Z</b>	VFAS3-2110P, VFAS3-2150P, VFAS3-2185P, VFAS3-4220PC, VFAS3-4300PC, VFAS3-4370PC	<b>PAGE 5-11</b>
<b>FOT022Z</b>	VFAS3-2220P, VFAS3-2300P, VFAS3-2370P, VFAS3-4450PC, VFAS3-4550PC, VFAS3-4750PC	<b>PAGE 5-11</b>

**⚠ CAUTION**  
**HAZARD OF EQUIPMENT DAMAGE**  
 Respect the information provided in the instruction to ensure the functioning of the product.  
**Failure to follow these instructions can result in injury or equipment damage.**



FOT021Z  
FOT022Z



FOT021Z  
FOT022Z

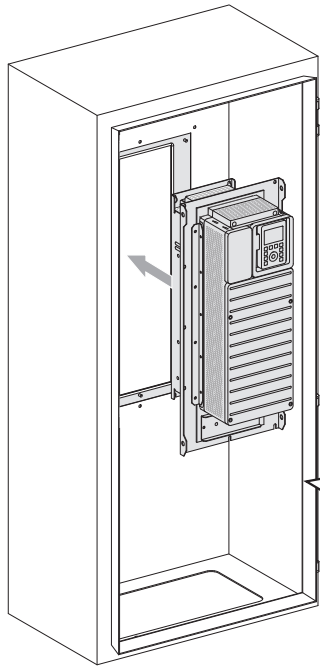

> 20 Kgs  
> 44.1 lbs



F<sub>2</sub>

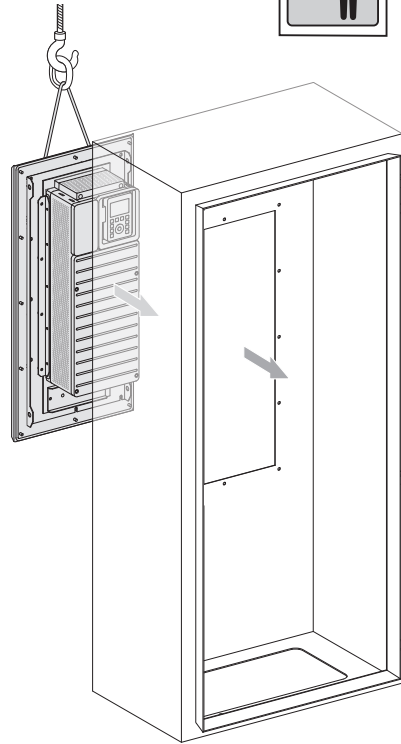

**A** FOT021Z

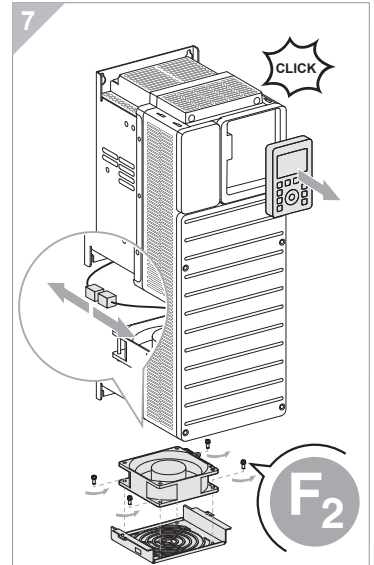
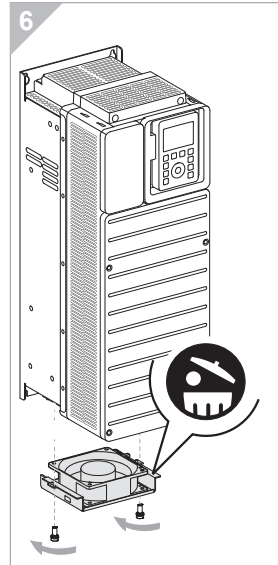
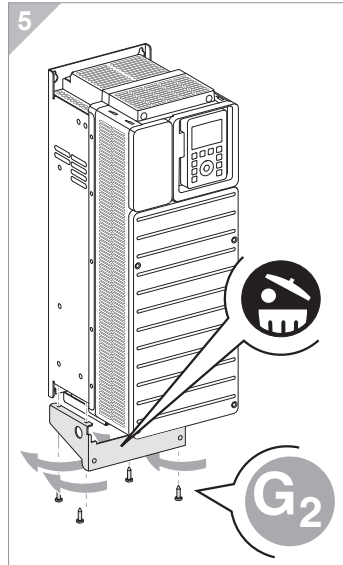
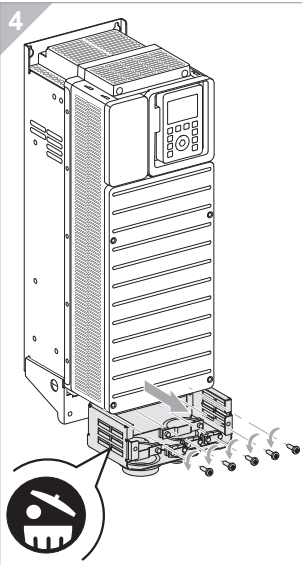
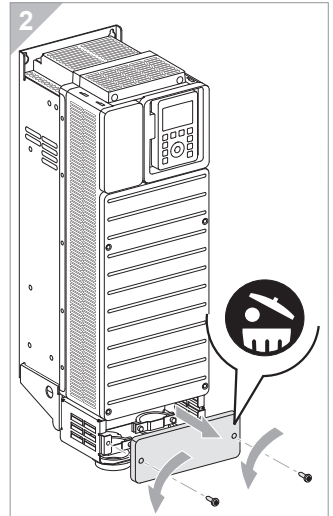
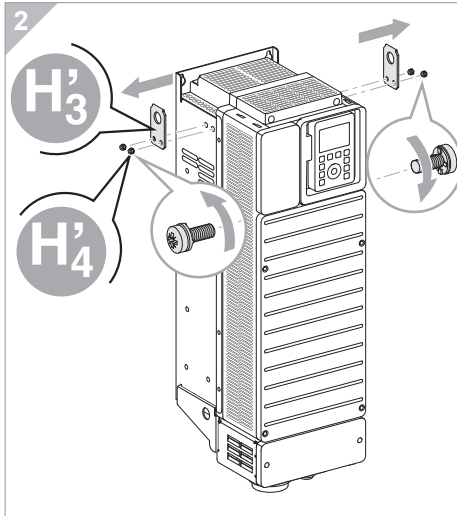
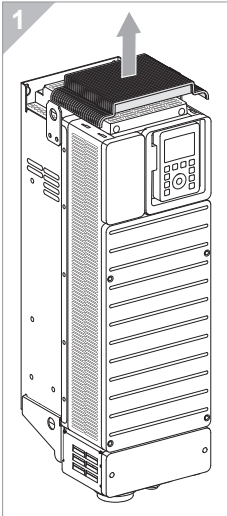
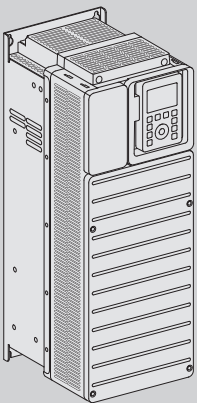

**A'** FOT022Z

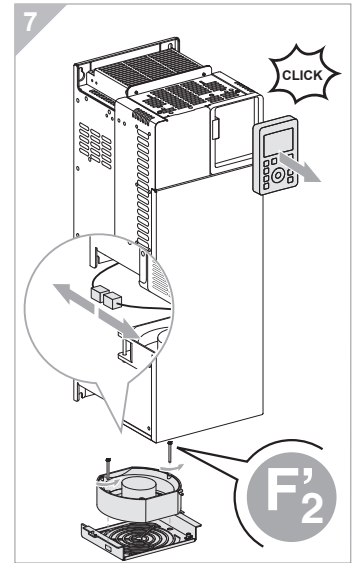
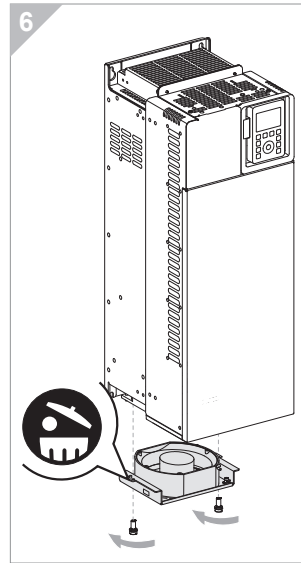
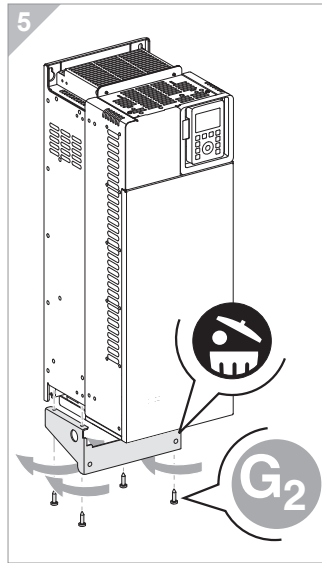
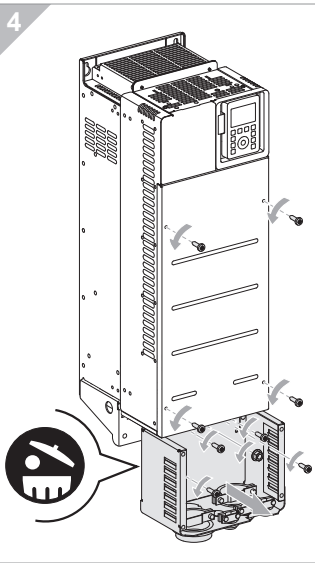
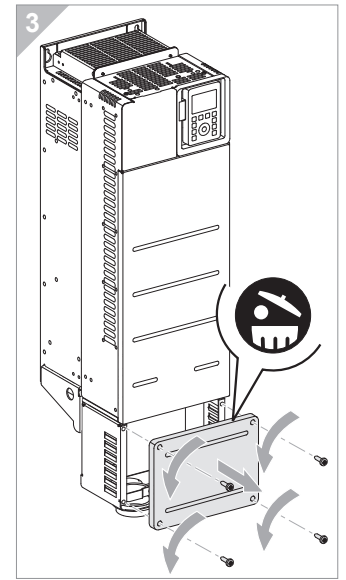
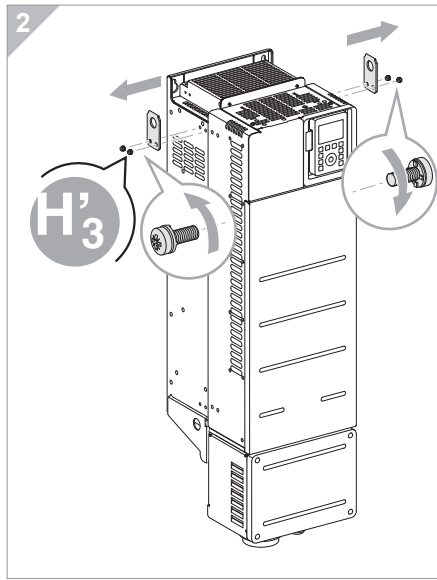
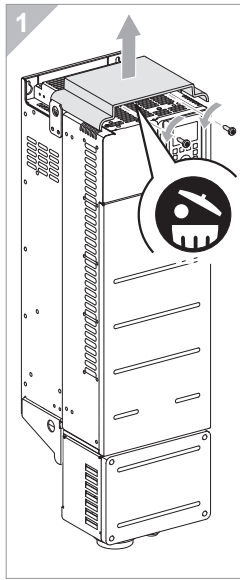
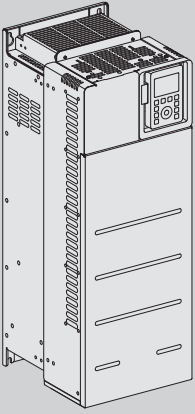

**B** FOT021Z  
FOT022Z

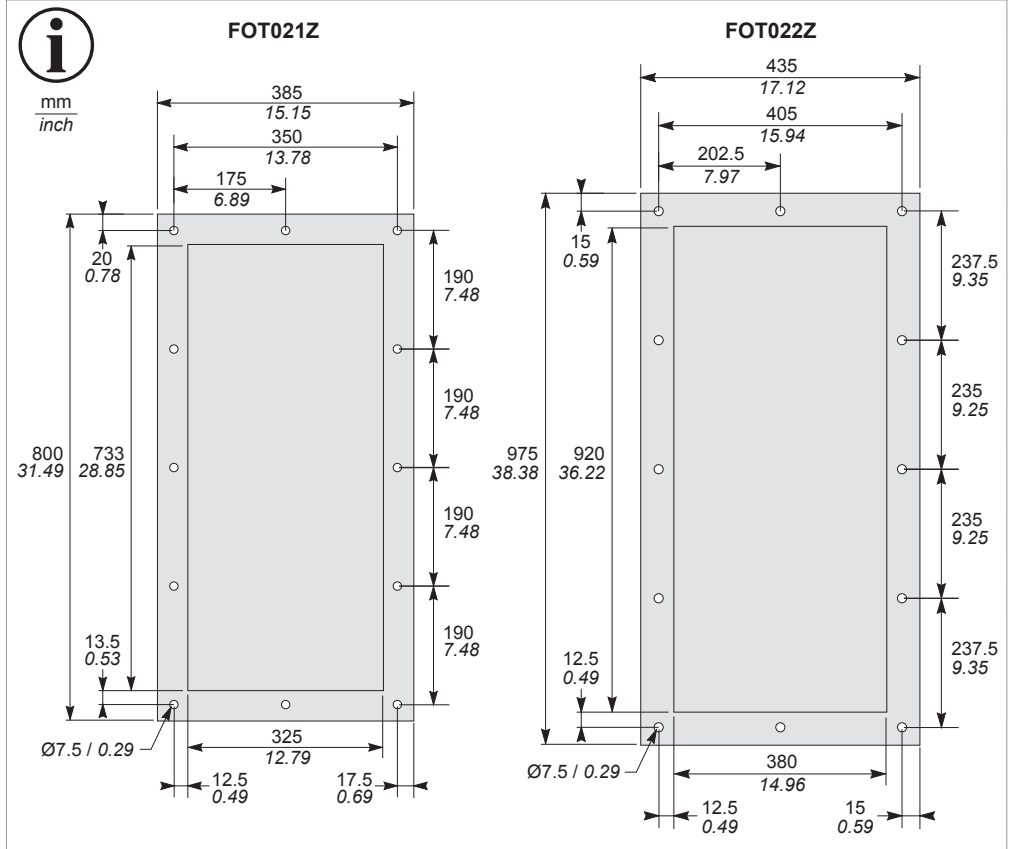
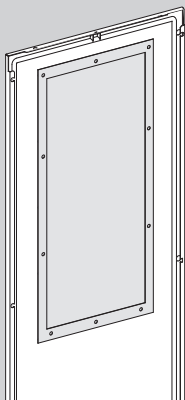



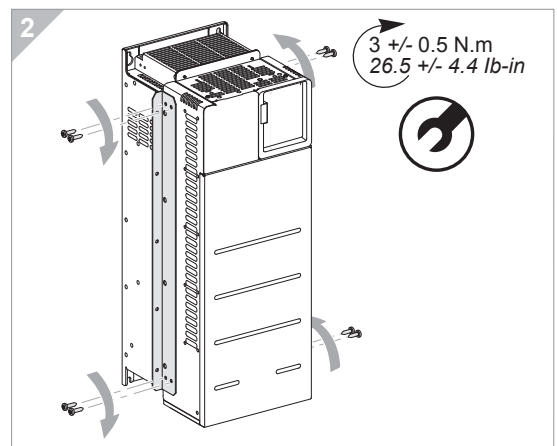
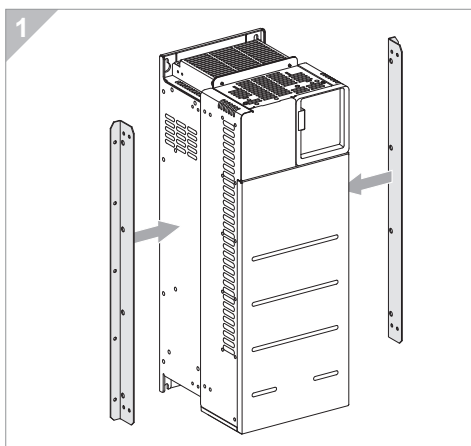
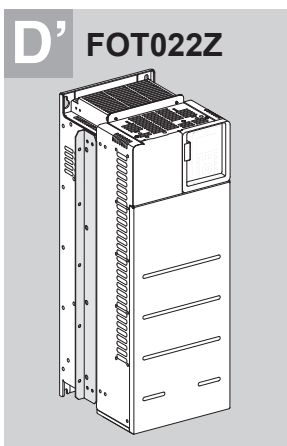
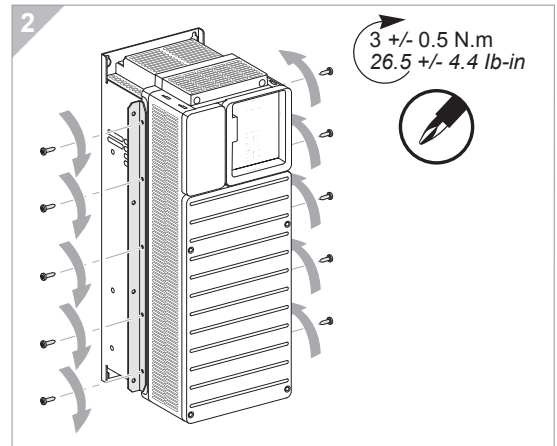
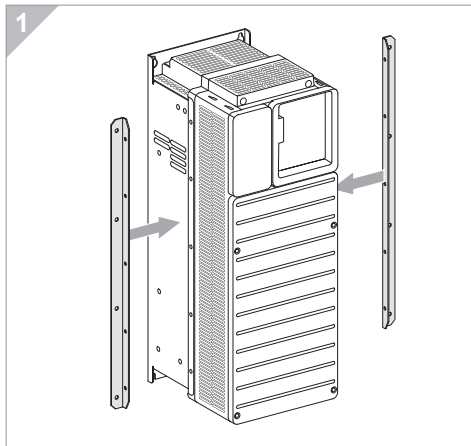
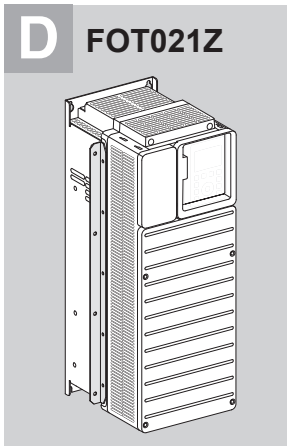
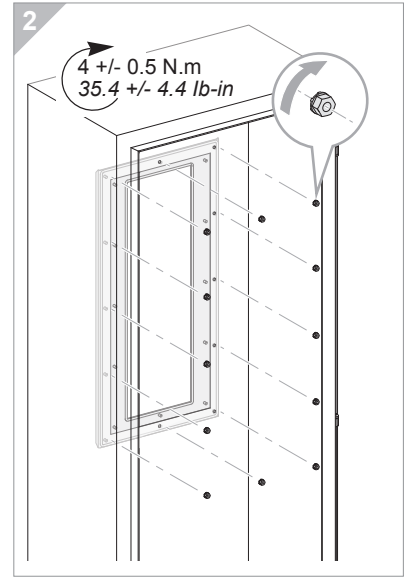
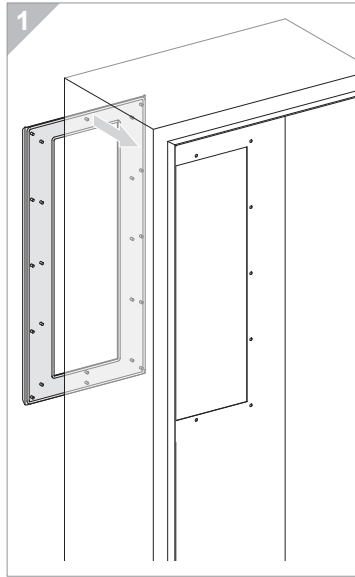
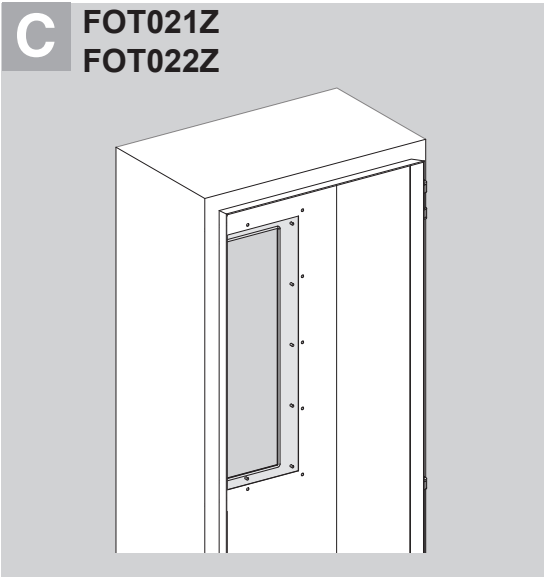
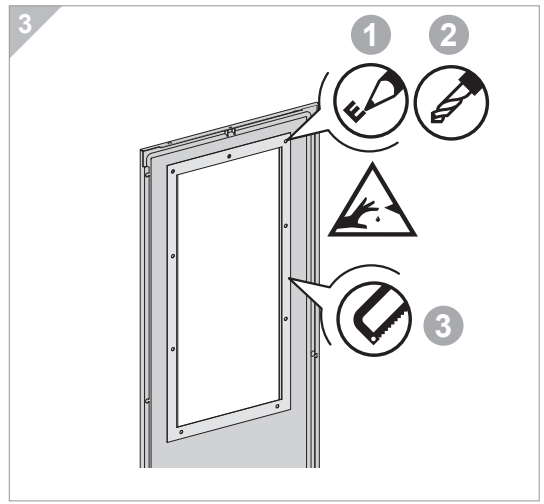
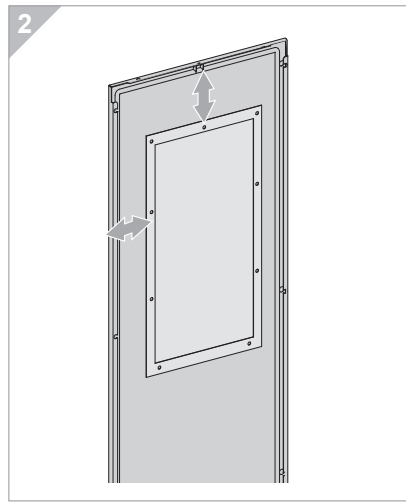
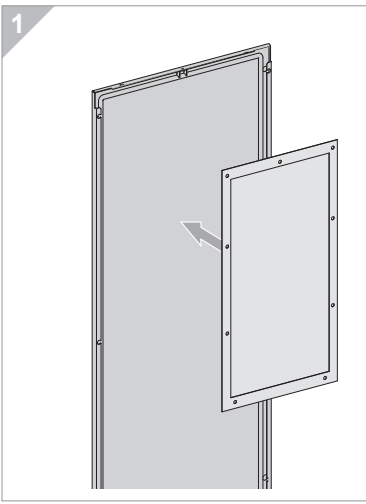

**E** FOT021Z  
FOT022Z

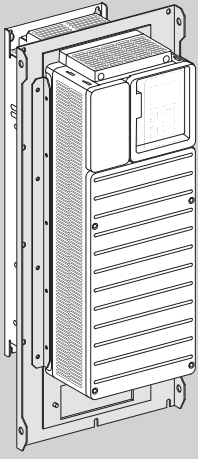

1

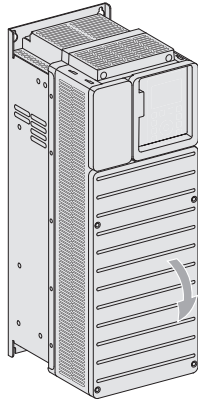

2

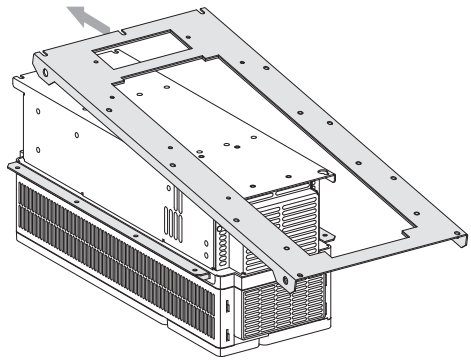

3

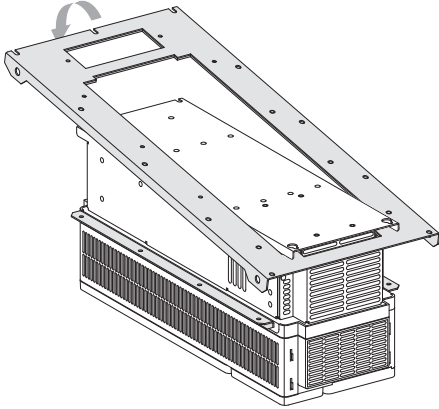

4

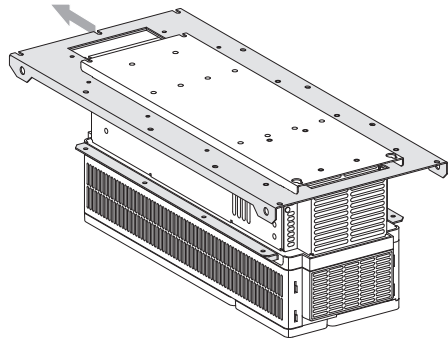

5

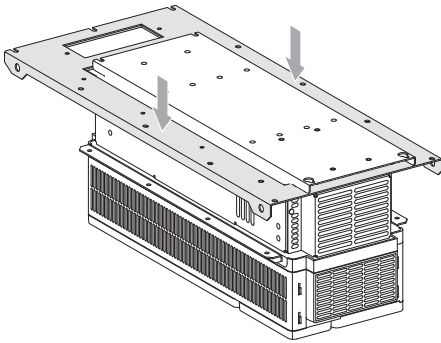

6

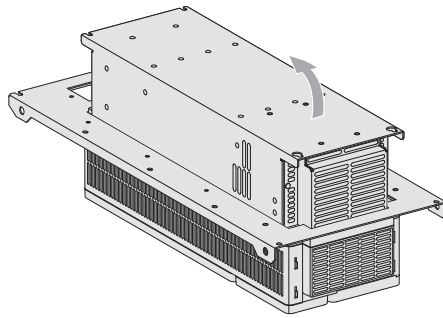

7

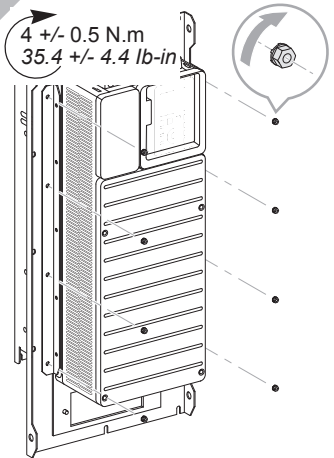

**F** FOT021Z

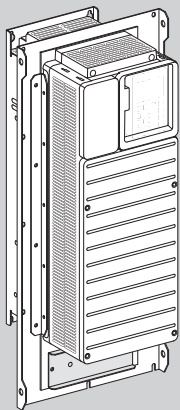

1

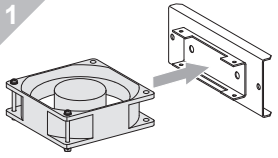

2

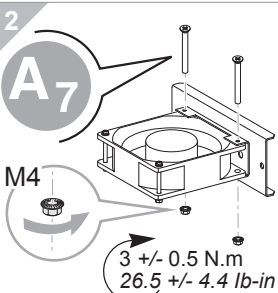

3

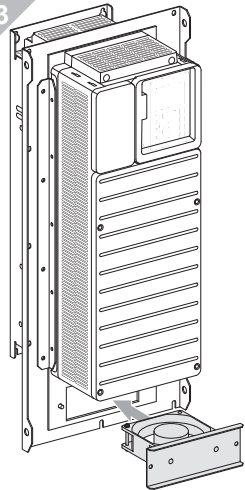

4

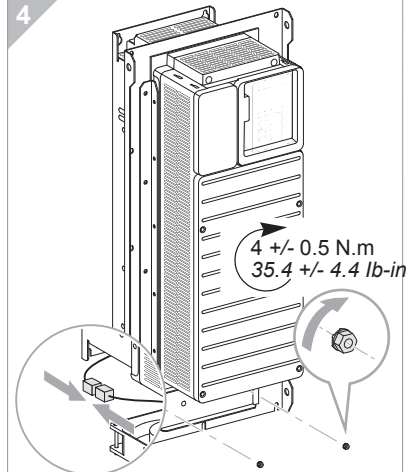

**F'** FOT022Z

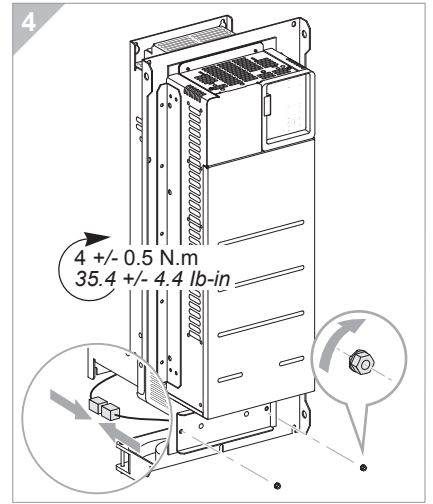
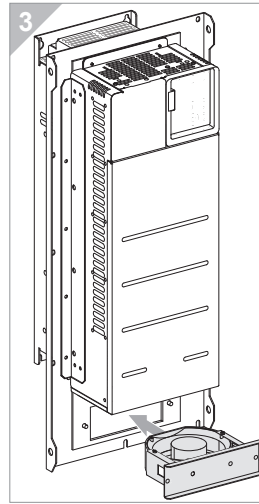
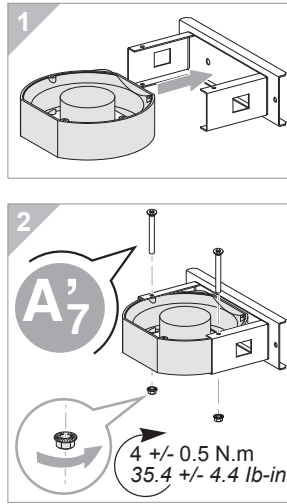
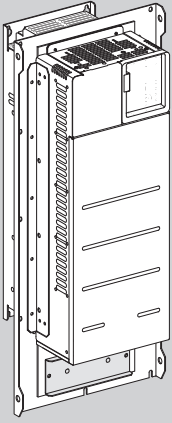

**G** FOT021Z  
FOT022Z

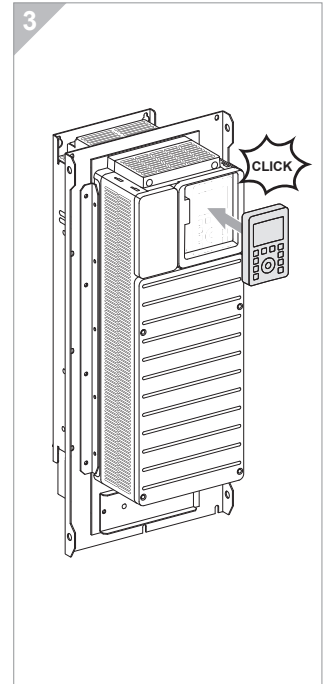
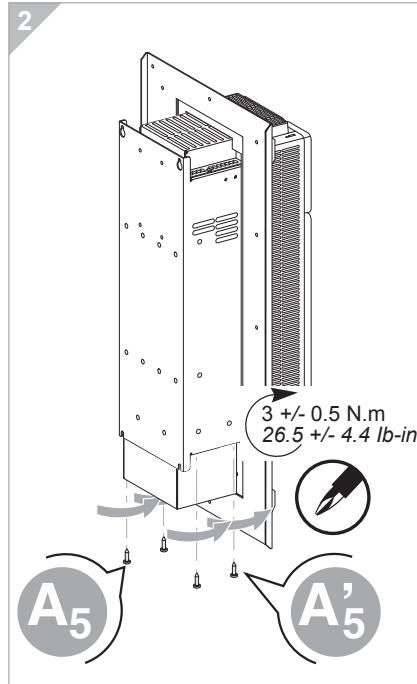
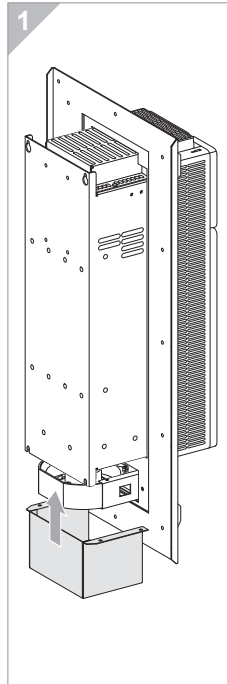
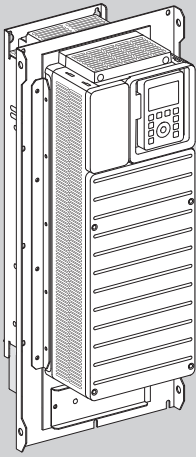

**H** FOT021Z  
FOT022Z

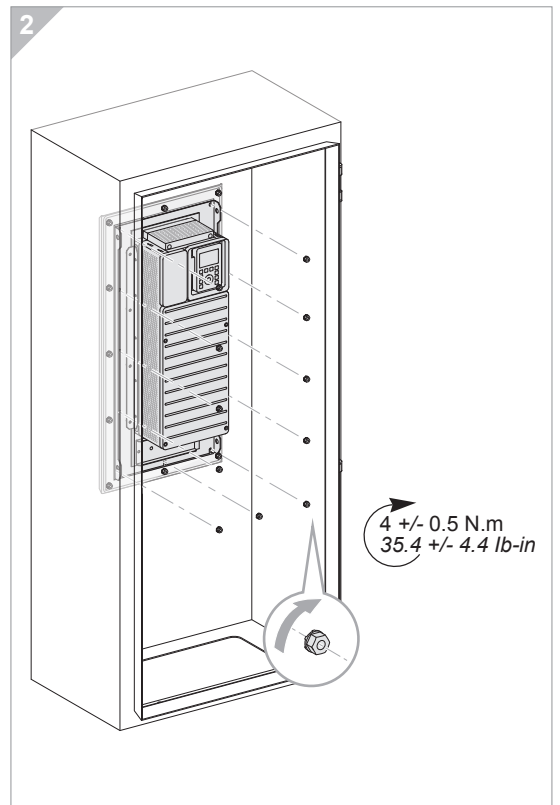
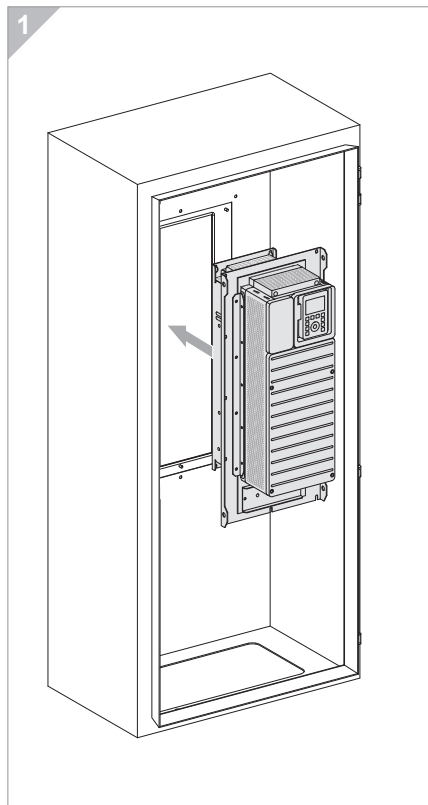
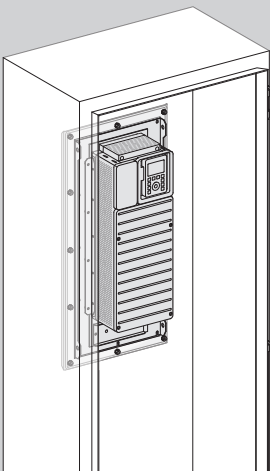

**H'** FOT021Z  
FOT022Z

